

COUNTY COUNCIL OF BALTIMORE COUNTY, MARYLAND
Legislative Session 2019, Legislative Day No. 7

Bill No. 12-19

All Councilmembers

By the County Council, April 1, 2019

A BILL
ENTITLED

AN ACT concerning

Basic Services Maps

FOR the purpose of repealing the Basic Services Sewerage Map, the Basic Services Water Supply Map and the Basic Services Transportation Map; and adopting a new Basic Services Sewerage Map, a new Basic Services Water Supply Map and a new Basic Services Transportation Map.

By repealing and reenacting, with amendments
Subsection 4A02.3.A.1.,2. and 3.
Baltimore County Zoning Regulations, as amended

BY repealing
2018 Basic Services Sewerage Map
2018 Basic Services Water Supply Map
2018 Basic Services Transportation Map, all as adopted by Bill No. 25-18

BY adopting the new
2019 Basic Services Sewerage Map
2019 Basic Services Water Supply Map
2019 Basic Services Transportation Map

EXPLANATION: CAPITALS INDICATE MATTER ADDED TO EXISTING LAW.
[Brackets] indicate matter stricken from existing law.
~~Strike out~~ indicates matter stricken from bill.
Underlining indicates amendments to bill.

WHEREAS, in accordance with Subsection 4A02.3.E. of the Baltimore County Zoning Regulations, the Planning Board has recommended revisions to the Basic Services Maps and submitted those recommendations to the County Council on February 21, 2019, and the County Council has held a public hearing thereon on April 1, 2019; now, therefore

1 SECTION 1. BE IT ENACTED BY THE COUNTY COUNCIL OF BALTIMORE
2 COUNTY, MARYLAND, that the Basic Services Maps referred to in Subsections 4A02.3.A.1.,
3 2. and 3. of the Baltimore County Zoning Regulations, and further identified as (1) 2018 Basic
4 Services Sewerage Map, (2) 2018 Basic Services Water Supply Map; and (3) 2018 Basic Services
5 Transportation Map, and any amendments and revisions previously made thereto are hereby
6 repealed.

7
8 SECTION 2. AND BE IT FURTHER ENACTED, that the Basic Services Maps
9 identified herein and accompanying this Act are hereby adopted and declared to be a part of this
10 Act and incorporated by reference herein. The following maps are hereby adopted and identified
11 as follows:

- 12 1. 2019 Basic Services Sewerage Map;
13
14 2. 2019 Basic Services Water Supply Map; and
15
16 3. 2019 Basic Services Transportation Map, WITH THE FOLLOWING

17 AMENDMENTS:

18 A. HARFORD ROAD AND EAST JOPPA ROAD – LEVEL OF SERVICE: F.

19 B. PADONIA ROAD AND DEERCO ROAD/BEAVER DAM ROAD AT A 600 FOOT
20 RADIUS FROM THE CENTER OF THE INTERSECTION – LEVEL OF SERVICE: F.

21

1 C. WHEN THE DEPARTMENT OF PUBLIC WORKS CONDUCTS NEW TRAFFIC
2 STUDIES, THE TRIANGULAR INTERSECTIONS OF BELAIR ROAD AND JERUSALEM
3 ROAD, BELAIR ROAD AND BRADSHAW ROAD/SUNSHINE AVENUE, AND
4 JERUSALEM ROAD AND BRADSHAW ROAD SHALL BE STUDIED
5 SIMULTANEOUSLY WHEN AREA PUBLIC AND PRIVATE SCHOOLS ARE IN SESSION.

6 D. THE COMMUTER SHED LOCATED AT THE INTERSECTION OF EBENEZER
7 ROAD AND PULASKI HIGHWAY SHALL BE REDRAWN TO EXCLUDE THE AREA OF
8 LAND ATTACHED AS EXHIBIT "A" AND DESCRIBED HEREIN AS FOLLOWS:
9 BEGINNING FOR THE SAME ON THE SOUTHEAST SIDE OF PULASKI HIGHWAY, 150
10 FEET WIDE, AT A POINT DESIGNATED WITH A MARYLAND STATE COORDINATE
11 VALUE OF NORTH 628782.41 AND EAST 1478470.26 AS SHOWN ON A PLAT
12 ENTITLED "FINAL PLAT, CECELIA SCHWABER, EXEMPT TRUST U/A" AND
13 RECORDED AMONG THE LAND RECORDS OF BALTIMORE COUNTY IN PLAT BOOK
14 S.M. 78, FOLIO 368; THENCE BINDING ON THE SOUTHEAST SIDE OF PULASKI
15 HIGHWAY AND ON THE OUTLINE OF SAID PLAT (1) NORTH 45 DEGREES 02
16 MINUTES 33 SECONDS EAST 1068.61; THENCE LEAVING SAID HIGHWAY AND
17 BINDING ON THE OUTLINES OF SAID PLAT THE FOLLOWING SIX COURSES AND
18 DISTANCES: (2) SOUTH 69 DEGREES 53 MINUTES 59 SECONDS EAST 70.16 FEET;
19 THENCE (3) SOUTH 06 DEGREES 21 MINUTES 02 SECONDS EAST 1947.07 FEET;
20 THENCE (4) SOUTH 82 DEGREES 05 MINUTES 22 SECONDS WEST 518.59 FEET;
21 THENCE (5) NORTH 07 DEGREES 00 MINUTES 39 SECONDS WEST 344.59 FEET;
22 THENCE (6) SOUTH 82 DEGREES 59 MINUTES 21 SECONDS WEST 365.35 FEET; AND
23 THENCE (7) NORTH 06 DEGREES 56 MINUTES 32 SECONDS WEST 985.35 FEET TO
24 THE PLACE OF BEGINNING.

1 CONTAINING 31.489 ACRES OF LAND, MORE OR LESS, WITH THE COURSES BASED
2 ON THE MARYLAND COORDINATE SYSTEM (NAD 83/91).
3 BEING KNOWN AND DESIGNATED AS #11301 PULASKI HIGHWAY – PARCEL 27, 230
4 AS SHOWN ON A PLAT ENTITLED “FINAL PLAT, CECELIA SCHWABER, EXEMPT
5 TRUST U/A” AND RECORDED AMONG THE LAND RECORDS OF BALTIMORE
6 COUNTY IN PLAT BOOK S.M. 78, FOLIO 368.
7 ALSO BEING ALL OF THAT LAND DESCRIBED IN A DEED DATED JANUARY 4, 2010
8 AND RECORDED AMONG THE LAND RECORDS OF BALTIMORE COUNTY IN LIBER
9 S.M. 29037, FOLIO 10 WAS CONVEYED BY REVOCABLE TRUST AGREEMENT OF
10 CECELIA SCHWABER DTD. DECEMBER 9, 1985 AND CECELIA SCHWABER EXEMPT
11 TRUST U/A DECEMBER 9, 1985 UNTO 11301 PULASKI HIGHWAY, LLC.

12

13 SECTION 3. AND BE IT FURTHER ENACTED, that upon the effective date of this
14 Act, the Maps adopted hereby shall be signed by the Chairman of the County Council and shall be
15 dated as of the effective date of this Act and thereafter delivered to the Department of Permits,
16 Approvals and Inspections.

17

18 SECTION 4. AND BE IT FURTHER ENACTED, that Subsection 4A02.3.A.1., 2. and
19 3. of the Baltimore County Zoning Regulations, be and they are hereby repealed and reenacted,
20 with amendments, to read as follows:

21

22 Section 4A02.3 - Basic Services Maps

23 4A02.3 - Adoption of Basic Services Maps

24 A. The following basic services maps, which shall be in the custody of the Zoning

1 Commissioner for Baltimore County and posted on the county’s internet website, are hereby
2 adopted and made a part of this Article:

- 3 1. [2018] 2019 Basic Services Sewerage Map
- 4 2. [2018] 2019 Basic Services Water Supply Map
- 5 3. [2018] 2019 Basic Services Transportation Map

6

7 SECTION 5. AND BE IT FURTHER ENACTED, that this Act, having been passed by
8 the affirmative vote of five members of the County Council, shall take effect on May 20, 2019.

Exhibit "A"

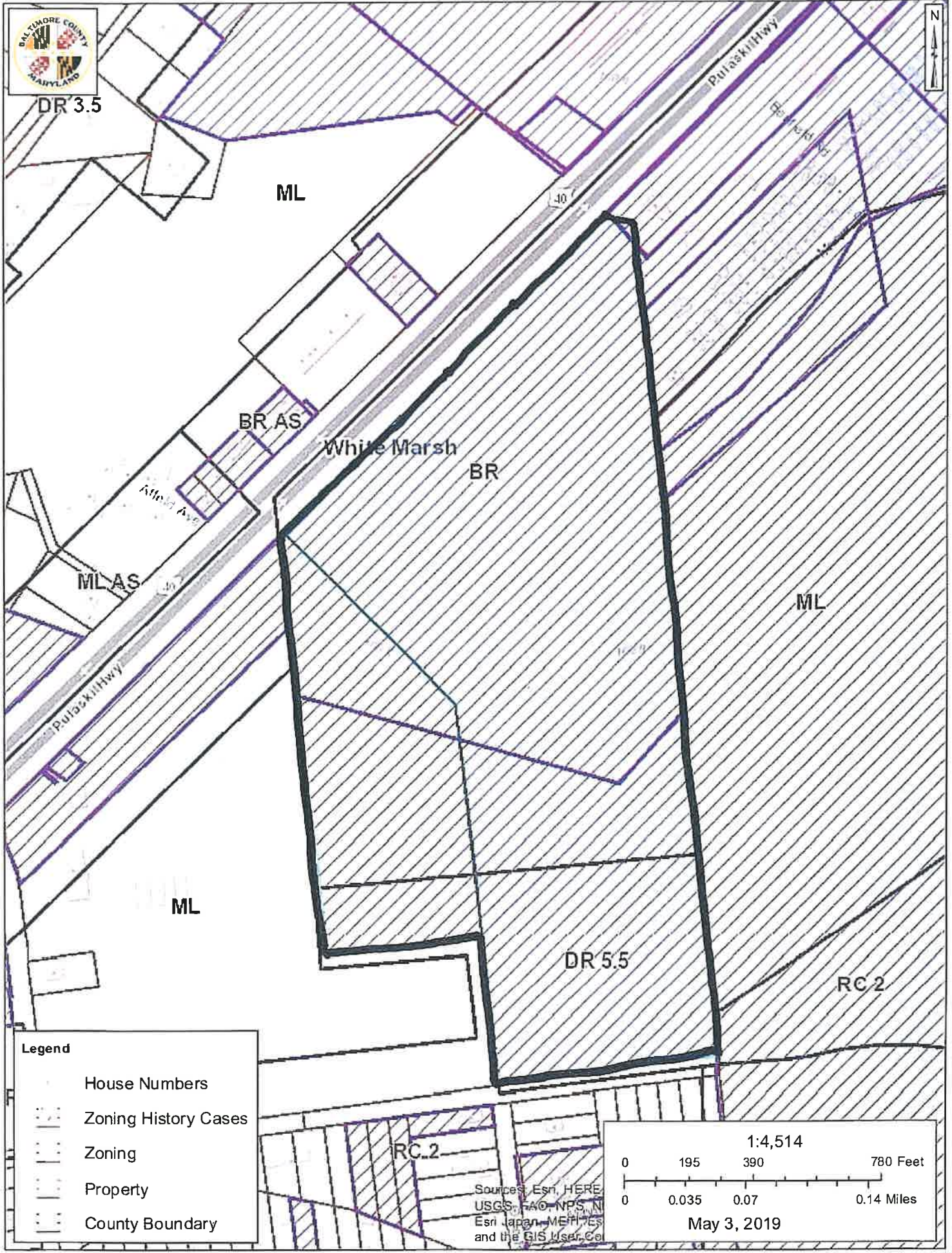

DR 3.5

ML

BR AS

White Marsh

BR

ML AS

ML

ML

DR 5.5

RC 2

RC.2

Legend

- House Numbers
- Zoning History Cases
- Zoning
- Property
- County Boundary

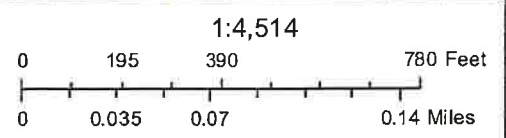

May 3, 2019

Sources: Esri, HERE, USGS, FAO, NPS, N, Esri Japan, METI, ES, and the GIS User Co.